

Manual Pull-Down Projection Screen

Accessories

- Wall mounting bracket (2pcs)
- $\phi 5 \times 40$ mm Tapping screw & cap (4sets)
- $\phi 5 \times 60$ mm Wood screw (4pcs)
- Top mounting bracket (2 pcs)
- M 6 x 12 Hexagon screw (4sets)
- Top mounting bracket (2pcs)
- M6x10 Screw (6pcs)
- Spring Washer (4pcs)

Getting Started

1. Make two marks for the holes where the screen will hang (use a level). For security, make sure that the 60mm wood screws hit studs when possible to better secure the screen to the wall. If studs are not available, use the included wall anchors.

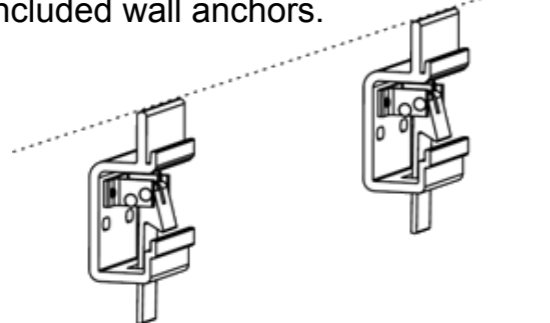

Installation Instructions

3. Insert the 40mm screws into the wall anchors through the mounting the brackets, as seen in Diagram A .
4. Hang the screen on the mounting brackets as seen in diagram B.
5. For ceiling installation, use the top mounting brackets as seen in diagram C.

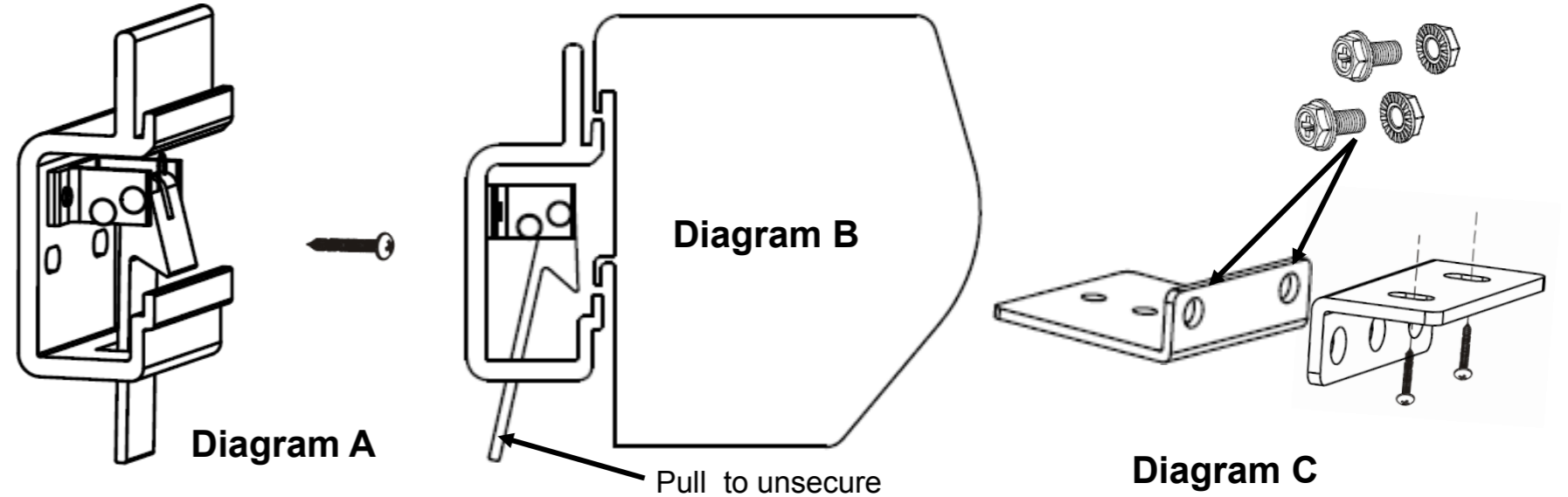

6. Pull down the desired height, pause for 3 seconds, and then the screen will self-lock.
7. To retract the screen, pull down lightly to release the locking system, and then let go. The screen will retract back into the casing.

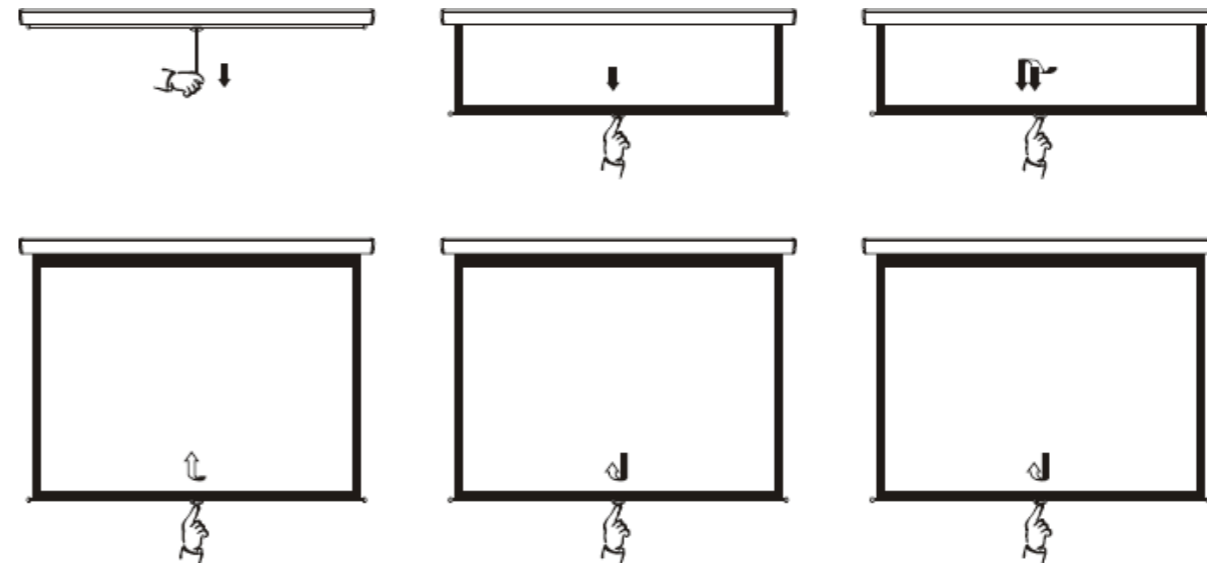

**Installation Help Line
(512) 832-6939**